

FLAIL MOWERS

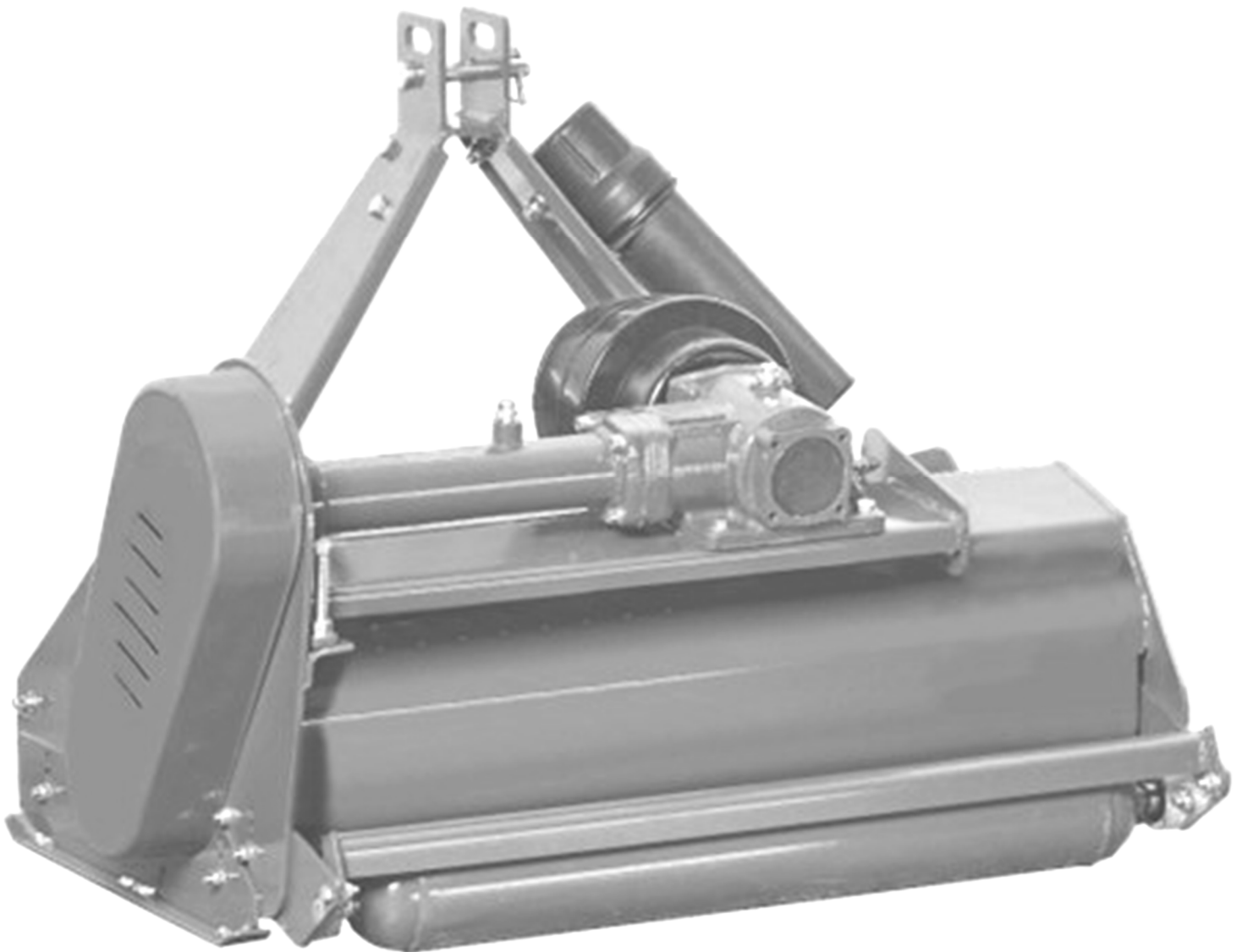

TO THE PURCHASER

This manual contains valuable information about your new King Kutter Flail Mower. It has been carefully prepared to give you helpful suggestions for operating, adjusting, servicing and ordering repair parts.

Keep this manual in a convenient place for quick and easy reference. Study it carefully. You have purchased a dependable and sturdy Flail Mower, but only by proper care and operation can you expect to receive the service and long life designed and built into the product.

Sometime in the future your Flail Mower may need new parts to replace. If so, go to your dealer and provide them with the model and part number.

Customer Information

Name _____

Purchased From _____

Date Purchased _____

Model No. _____

Serial No. _____

It is the purchaser and/or operator's responsibility to....

- I Read and understand the information contained in this manual.**
- I Operate, lubricate, assemble and maintain the equipment in accordance with all instructions and safety procedures in this manual.**
- I Inspect the equipment and replace or repair any parts that are damaged or worn which under continued operation would cause damage, wear to other parts, or cause a safety hazard.**
- I Return the equipment or parts to the authorized King Kutter dealer, from where it was purchased, for service or replacement of defective parts that are covered by warranty. (The King Kutter Factory or an Authorized King Kutter Dealer may inspect equipment or parts before warranty claims are honored.)**

CONTENTS

ITEM	PAGE
Safety	6
Safety Training	8
Operational Safety.....	10
Transportation & Storage Safety	12
Safety Decals	13-15
Safety Signs Locations	16
Introduction & Specifications	17
Before Operation & Adjusting Height.....	18
Flail Mower Adjustment & Belt Tension.....	19
Attaching To Tractor.....	20
Sizing PTO Shaft	22
Service & Maintenance.....	23
Storage & Operation After Storage	24
Replacement Parts	25
Warranty	28

SAFETY

READ AND FOLLOW THE INSTRUCTIONS IN THIS MANUAL AND ESPECIALLY IN THE SAFETY SECTION. FAILURE TO DO SO CAN RESULT IN SERIOUS INJURY OR DEATH.

TAKE NOTE! THIS SAFETY ALERT SYMBOL FOUND THROUGHOUT THIS MANUAL IS USED TO CALL YOUR ATTENTION TO INSTRUCTIONS INVOLVING YOUR PERSONAL SAFETY AND THE SAFETY OF OTHERS.



THIS SYMBOL MEANS
ATTENTION!
BECOME ALERT!
YOUR SAFETY IS INVOLVED

SIGNAL WORDS:

The signal words **DANGER**, **WARNING** and **CAUTION** are used with the safety messages in this manual and with each safety sign. They are defined as follows:

DANGER: Indicates an immediate hazardous situation that, if not avoided, could result in serious injury or death. This signal word is to be limited to the most extreme situations typically for machine components that, for functional purposes, cannot be guarded.

WARNING: Indicates a potentially hazardous situation that, if not avoided, could result in serious injury or death, and includes hazards that are exposed when guards are removed. It may also be used to alert against unsafe practices.

CAUTION: Indicates a potentially hazardous situation that, if not avoided, may result in minor or moderate injury. It may also be used to alert against unsafe practice.

If you have any questions not answered in this manual or require additional copies or the manual is damaged, please contact your dealer or King Kutter, Inc.

P.O. Box 1200 Winfield, AL 35594 (205) 487-3202 or www.kingkutter.com

EQUIPMENT SAFETY GUIDELINES



- I Safety of the operator and bystanders is one of the main concerns in designing and developing a Flail Mower. However, every year accidents occur which could have been avoided by a few seconds of thought and a more careful approach to handling equipment. You, the operator, can avoid many accidents by observing the following precautions and insist those working with you, or for you, follow them.
- I In order to provide a better view, certain photographs or illustrations in this manual may show an assembly with a safety shield removed. However, equipment should never be operated in this condition. Keep all shields in place. If shield removal becomes necessary for repairs, replace the shield prior to use.
- I Replace any safety sign that is not readable or is missing. Copies of such safety signs are shown in this manual.
- I Never use alcoholic beverages or drugs that can hinder alertness or coordination while operating this equipment. Consult your doctor about operating this machine while taking prescription medications.
- I **Under no circumstances should children under the age of 18 be allowed to work with this equipment. Do not allow persons to operate or assemble this unit until they have read this manual and have developed a thorough understanding of the safety precautions and of how it works.** Review the safety instructions with all users annually.
- I This equipment is dangerous to children and persons unfamiliar with its operation. The operator should be a responsible, properly trained and physically able person familiar with farm machinery and trained in this equipment's operations. If the elderly are assisting with farm work, their physical limitations need to be recognized and accommodated.
- I Use a tractor equipped with a Roll Over Protective System and seat belts. (ROPS)
- I Never exceed the limits of a piece of machinery. If its ability to do a job, or to do so safely, is in question- **DON'T TRY IT.**
- I Do not modify the equipment in any way. Unauthorized modification could result in serious injury or death and may impair the function and life of the equipment.
- I In addition to the design and the confirmation of this implement, including safety signs and safety equipment, hazard control and accident prevention are dependent upon the awareness, concern, prudence, and proper training of personnel involved in the operation, transport, maintenance, and storage of the machine. Refer also to safety messages and operation instruction in each of the appropriate sections of the tractor and Flail Mower manuals. Pay close attention to the safety signs affixed to the tractor and the Flail Mower.

SAFETY TRAINING



- I Safety is a primary concern in the design and manufacture of our product. Unfortunately, our efforts to provide safe equipment can be wiped out by a single careless act of an operator or bystander.
- I In addition to the design and configuration of equipment, hazard control and accident prevention are dependent upon the awareness, concern, prudence and proper training of personnel involved in the operation, transport, maintenance and storage of this equipment.
- I It has been said, “The best safety device is an informed, careful operator.” We ask you to be that kind of operator. It is the operator’s responsibility to read and understand all safety and operating instructions in the manual and to follow them. Accidents can be avoided.
- I Working with unfamiliar equipment can lead to careless injuries. Read this manual, and the manual for your tractor, before assembly or operating, to acquaint yourself with the machines. If this machine is used by any person other than you, or is loaned or rented, it is the Flail Mower owner’s responsibility to make certain that owner's manual be available to the operator prior to operating and that the operator:
 - 1- Reads and understands the operator’s manuals.
 - 2- Is instructed in safe and proper use.
- I Know your controls and how to stop tractor, engine, and the Flail Mower quickly in an emergency. Read this manual and the one provided with your tractor.
- I Train all new personnel and review instructions frequently with existing workers. Be certain only a properly trained and physically able person will operate the machinery. A person who has not read and understood all operating and safety instructions is not qualified to operate the machine. An untrained operator exposes himself and bystanders to possible serious injury or death. If the elderly are assisting with farm work, their physical limitations need to be recognized and accommodated.

PREPARATION



- I Never operate the tractor and Flail Mower until you have read and completely understand this manual, the Tractor Operator's Manual, and each of the safety messages found on the safety signs on the tractor and mower.
- I Personal protection equipment including hardhat, safety glasses, safety shoes, and gloves are recommended during assembly, installation, operation, adjustment, maintenance, repairing, removal, or moving the implement. Do not allow long hair, loose fitting clothing, or jewelry to be around equipment.
- I **PROLONGED EXPOSURE TO LOUD NOISE MAY CAUSE PERMANENT HEARING LOSS!** Tractors with or without Flail Mowers attached can often be noisy enough to cause permanent, partial hearing loss. We recommend that you wear hearing protection on a full-time basis if the noise in the operator's position exceeds 80 db. Noise over 80 db. on a long-term basis can cause severe hearing loss. Noise over 90 db. adjacent to the operator over a long-term basis may cause permanent, total hearing loss. **NOTE:** Hearing loss from loud noise (from tractors, chain saws, radios, and other such sources close to the ear) is cumulative over a lifetime without hope of natural recovery.
- I Operate the Flail Mower only with a tractor equipped with an approved Roll-Over-Protective System (ROPS). Always wear your seat belt. Serious injury or even death could result from falling off the tractor — particularly during a turnover when the operator could be pinned under the ROPS or the tractor.
- I Operate only in daylight or good artificial light.
- I Ensure the Flail Mower is properly mounted, adjusted and in good operating condition.
- I Ensure that all safety shielding and safety signs are properly installed and in good condition.

STARTING AND STOPPING SAFETY



- I Check the tractor master shield over the PTO stub shaft. Make sure it is in good condition and fastened securely to the tractor. Replace with a new shield if old shield is damaged or missing.
- I All tractors that are not equipped with a "live" power takeoff (PTO) need to be equipped with an over-running PTO clutch. These are available through most farm equipment stores. **NOTE:** The addition of an over-running PTO clutch may change the length of the PTO driveline required. Pay extra attention to the instructions on the PTO driveline Installation. Be sure that the driveline system guarding is adequate.
- I The Flail Mower operating power is supplied from the tractor PTO. Refer to your tractor manual for PTO engagement and disengagement instructions. Know how to stop tractor and Flail Mower quickly in case of an emergency.

OPERATIONAL SAFETY



This mower is designed for pulverizing grass and small brush, shrubs and vines. It is **not** intended for any other use! Using the product for anything other than its designed purpose could result in serious injury or death!

- I The use of this equipment is subject to certain hazards that cannot be protected against by the mechanical means or product design. All operators of this equipment must read and understand this entire manual, paying particular attention to safety and operating instructions, prior to using. If there is something in this manual you do not understand, ask your supervisor, or your dealer, to explain it to you.
- I Most accidents occur because of neglect or carelessness. Keep all helpers and bystanders at least several feet from an operating Flail Mower. Only properly trained people should operate this mower.
- I When the mower is operated in an area with people present, **operation must be stopped when anyone comes within 25 feet.**
- I The majority of the accidents involve entanglement on the driveline and operators being knocked off the tractor by low hanging limbs. Accidents are most likely to occur with mowers that are loaned or rented to someone who has not read the owner's manual and is not familiar with a Flail Mower and or a tractor.
- I The Flail Mower is designed for use only on tractors with **540-RPM** power take off.
- I Install and secure all guards and shields before starting or operating mower. The driveline guards and tractor shields should be used and maintained in good working condition. They should be inspected carefully, at least daily, for missing or broken cable, chain links, shields, or guards. (Worn items must be replaced at once to reduce possibility of injury)
- I Disengage power takeoff (PTO) and place transmission in neutral before attempting to start engine.
- I Many varied objects, such as wire, cable, rope, or chains, can become entangled in the operating parts of the mower. These items could then be thrown at great velocities. Such a situation is extremely hazardous. Inspect the area for such objects before mowing. Remove any like objects from the site.
- I Never allow the mower to contact such items. Never assume an area is clear.
Always Check!



- I Always stop the tractor, disengage PTO, set brake, shut off the tractor engine, remove the ignition key, lower mower to the ground and allow to come to a complete stop before dismounting tractor. Never leave equipment unattended with the tractor running.
- I Never place hands or feet close to the Flail Mower with tractor engine running or before you are sure all motion has stopped. Stay clear of all moving parts.
- I Do not reach or place any part of your body close to equipment until it is stopped and blocked securely.
- I Do not allow riders on the tractor or mower at anytime. There is no safe place for any riders.
- I Do not operate unless all personnel, livestock, and pets are several feet away to prevent injury.
- I The rotating parts of this machine have been designed and tested for rugged use. However, they could fail upon impact with heavy, solid objects such as steel guardrails and concrete abutment. Such impact could cause the broken objects to be thrown outward. To reduce the possibility of property damage, serious injury, or even death, never allow the mower to contact such obstacles.
- I Stop the mower and tractor immediately upon striking an obstruction. Turn engine off, remove key, inspect and repair any damage before resuming operation.
- I Stay alert for uneven terrain, rocks, and roots and other hidden hazards. Keep away from drop-offs and hazards that could cause roll over. Use extreme care and maintain minimum ground speed when transporting or operating on hillsides, over rough ground and when operating close to ditches or fences. Be careful and slow down when turning sharp corners and changing direction on slopes. Do not start or stop suddenly on slopes. Avoid operation on steep slopes. In extremely uneven terrain, rear wheels weights, front tractor weight, and/or tire ballast should be used to improve stability.
- I Always check tractor manual for proper use on slopes.
- I When using a unit, a minimum 20% of tractor and equipment weight must be on tractor front wheels. Without this weight, tractor could tip over, causing personal injury or death. The weight may be attained with a front- end loader, front wheel weights, ballast in the tires or front tractor weights. When attaining a minimum 20% of tractor and equipment weight on the front wheels, you must not exceed the ROPS weight certification. Weigh the tractor and equipment. **Do not guess or estimate!**
- I Avoid contact with any overhead utility lines or electrically charged conductors.
- I Do not operate the mower when it is more than 12" above the ground level or the driveline may bind causing injury to the operator and damage to the equipment.
- I Objects and people can be thrown or become entangled in the unit.

TRANSPORT SAFETY



- I Comply with state and local laws governing highway safety and movement of farm machinery on public roads.
- I The use of flashing amber lights is acceptable in most localities. However, some localities prohibit their use. Local laws should be checked for all lighting and marking requirements.
- I At all times, when driving the tractor and equipment on the road or highway under 20mph (32kph) use flashing amber warning lights and a slow moving vehicle (SMV) identification emblem. Do not exceed 20 mph (32 kph). Reduce speed on rough roads and surfaces.
- I Plan your route to avoid heavy traffic.
- I Always install transport locks, pins or brackets before transporting.
- I Do not drink and drive.
- I Be a safe and courteous driver. Always yield to oncoming traffic in all situations, including narrow bridges, intersections, etc. Watch for traffic when operating near or crossing roadways.
- I Turn curves or go up or down hills only at a low speed and at a gradual steering angle. Make certain that a least 20% of the tractor's weight is on the front wheels to maintain safe steering. Slow down on rough or uneven surface. Always check tractor manual for proper use on slopes.
- I Be careful when turning sharp corners.
- I Never allow riders on either tractor or mower.

STORAGE SAFETY



- I Following operation, or when unhooking the mower, stop the tractor, set the brakes, disengage the PTO, shut off the engine and remove the ignition keys.
- I Store the unit in an area away from human activity.
- I Do not park equipment where it can be exposed to direct contact to livestock for long periods of time. Damage and livestock injury could result.
- I Make sure all parked machines are on a hard, level surface and engage all safety devices.

SAFETY SIGNS

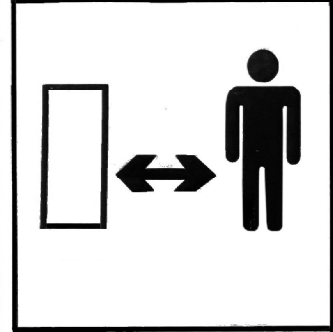
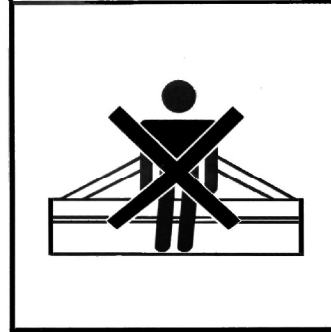

1

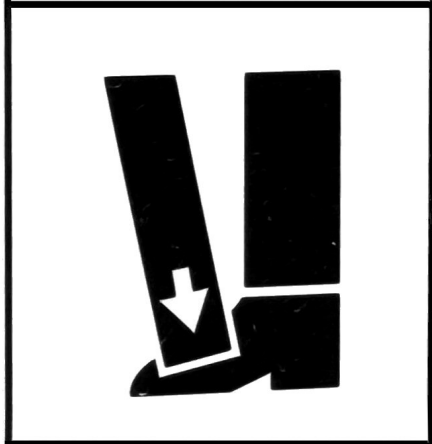

2

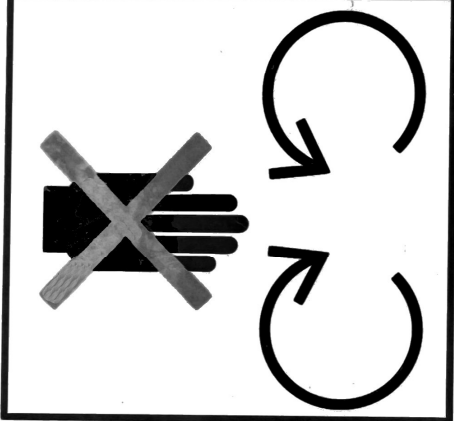

3





7 03996 00518 8

MODEL NO.

DESCRIPTION

SN# XXXXXXXXXXXX

4

**Operators Manuals & Parts
are available from
your dealer, or
King Kutter, INC.
Winfield, AL 35594
(205) 487-3202
or
www.kingkutter.com**

6

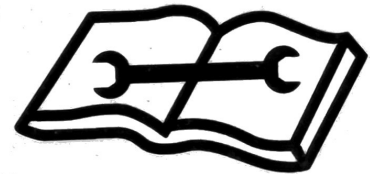

5

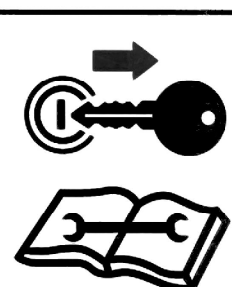
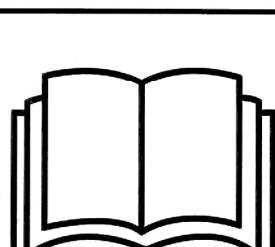
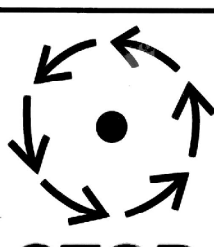
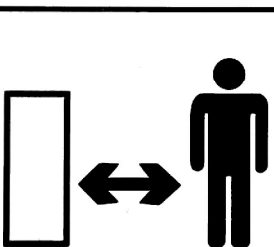

7

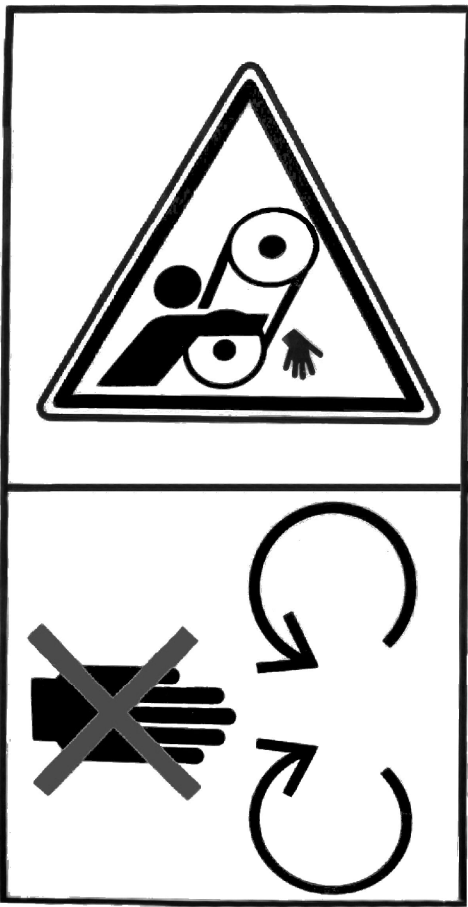

8



9



10



11

SAFETY SIGNS LOCATIONS

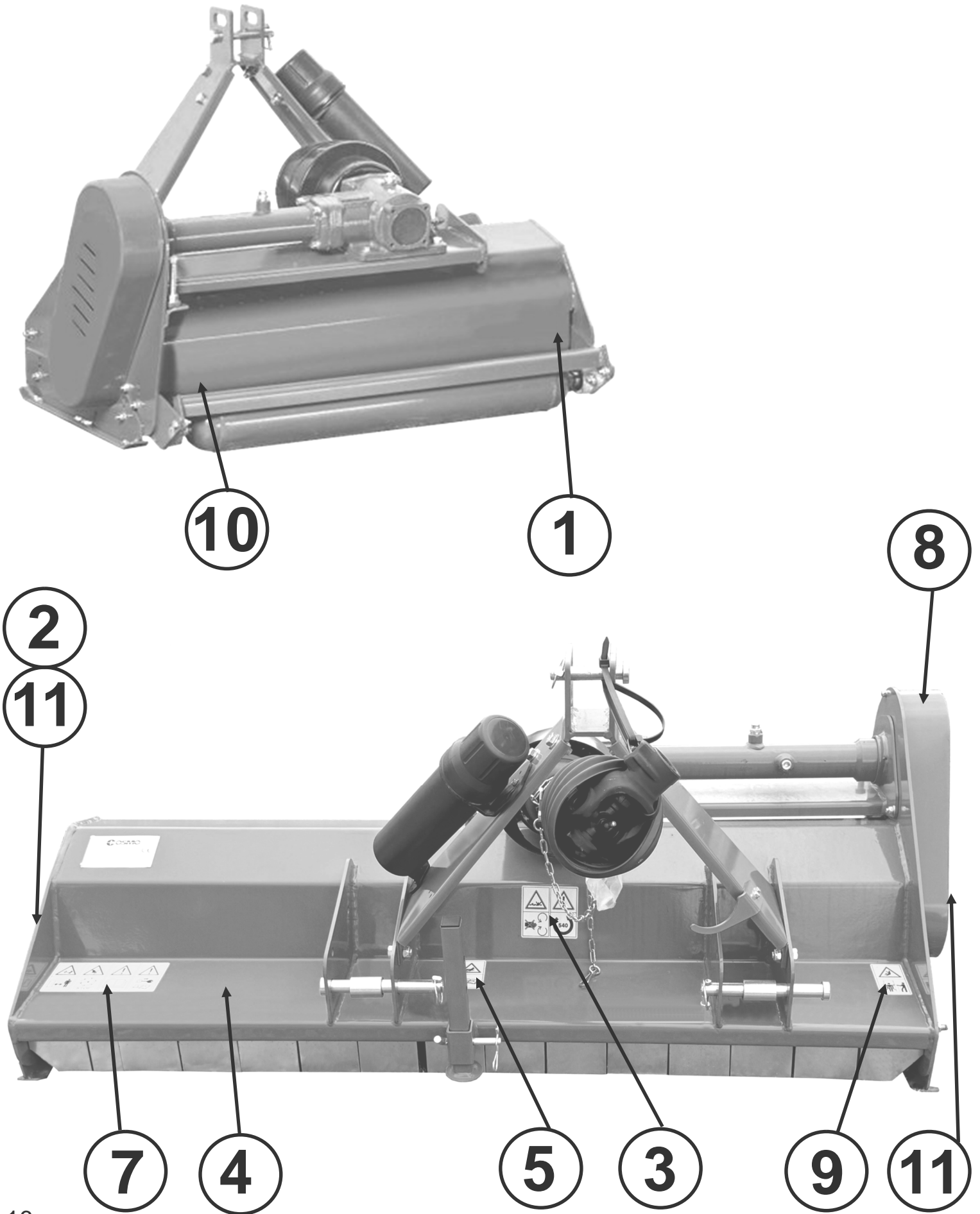

Introduction

The flail mower is designed for pulverizing grass and small brush, shrubs and vines. It should only be used for its intended purpose only.

The flail mower consists of a rotating shaft with many blades attached to it. The blades cut the grass while traveling over the working area. Power to the shaft is provided by the tractor PTO, through the gear box of the mower.

The flail mower attaches to the 3-point hitch of the tractor.

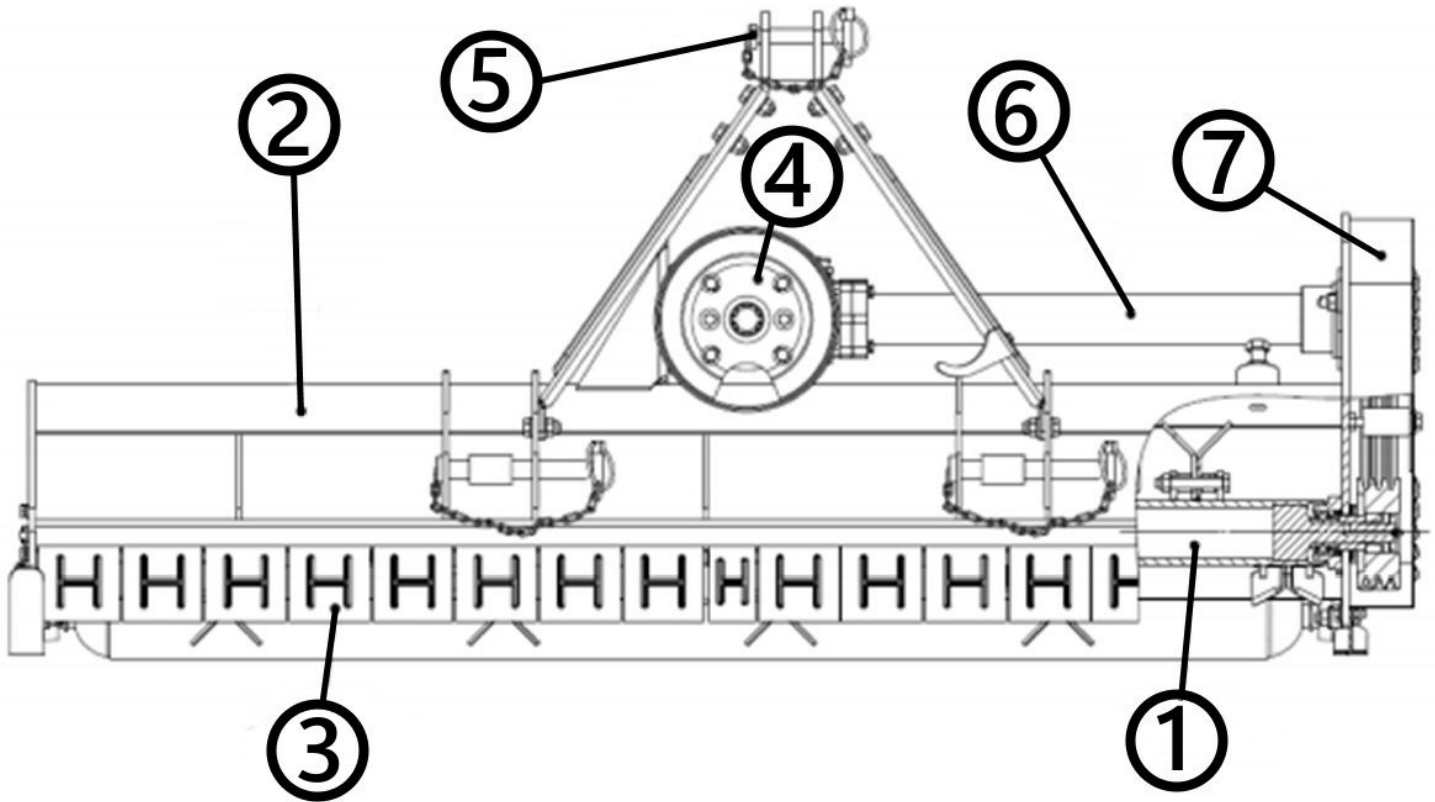

Main Components of the Flail Mower

1. Rotor 2. Machine Frame 3. Combined Fender 4. Gearbox Assembly
5. 3-Point Hitch 6. Transmission Shaft 7. Side Belt Transmission

SPECIFICATIONS

MODEL	FL-56-KK	FL-65-KK
Weight	419 lb.	518 lb.
Working Width	56 in.	64 in.
PTO RPM	540 RPM	540 RPM
Flail Type	Y Blade or Hammer Blade	
Number of Y Blades	48	52
Number of Hammer Blades	24	26
Tractor HP	25-35hp	30-40hp

BEFORE OPERATION

CAUTION: Be familiar with the mower before starting. Read this manual carefully to learn how to operate the machine safely and how to set it up for maximum efficiency.

Check Before Operating

ATTENTION: Before operating the mower, check the following areas.

1. Check and lubricate all grease points and all parts that require lubrication.
2. Use only a tractor of recommended horsepower for your specific mower.
3. Check that the mower is properly attached to the tractor. Be sure pin clips are secure on the lift pins and top link.
4. Be sure to check the weight distribution of the tractor to mower and add weight to front of tractor as needed.
5. Check the oil level in the gearbox and add as required.
6. Check that the PTO shaft turns freely and the shaft telescopes easily.
7. Check the mower blades to be sure they are not missing, damaged or broken and that they swing freely in their mount. Repair or replace as required.
8. Check and tighten the blade bolts.
9. Check for anything that may be entangled around all rotating parts and remove.
10. Install and secure all guards, doors and covers before starting.
11. Before installing the PTO shaft make sure the tractor and the mower are completely stopped. Make sure the PTO shaft is in good shape and all the parts are there.
12. Check the safety chains on the PTO shaft to be sure they are in good working condition in case the shaft turns accidentally.
13. All bystanders must keep a distance of 25 ft. before starting the mowing operation. The PTO shaft runs at 540 RPM.
14. Before you clean, repair or lubricate the mower, stop the tractor and remove the key.
15. Do not let anyone approach the mower while it is running.

ADJUSTING THE HEIGHT

To get the most out of your flail mower, it should be set within the recommended height.

To save fuel and power and to reduce wear and tear, the cutting height must be set properly.

When adjusting the working height, loosen screw (1), remove screw (2) on both sides. The roller height (see drawing) can be adjusted by aligning the selected hole in the roller support bracket at position 2. The lowest hole is the highest working height; put the screw (2) into the selected hole; tighten screw (1) and (2).

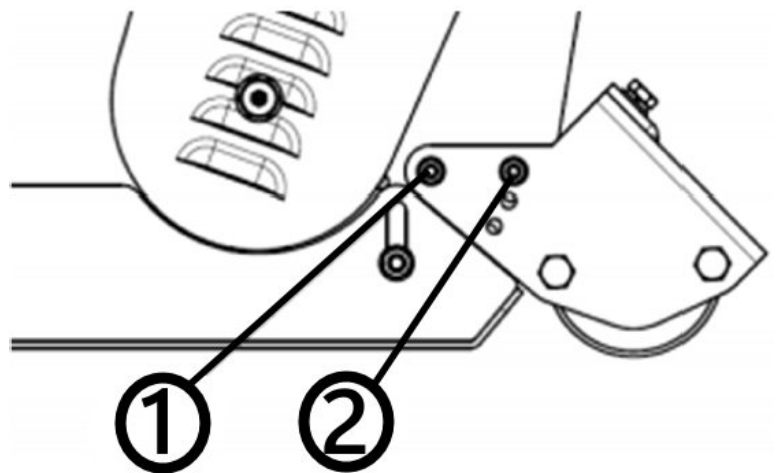

Flail Mower Adjustment

1. On flat ground, attach the Flail Mower to the Tractor using the three point linkage.
2. Use a solid adjustable top link
3. Lower the three point linkage to its lowest position.
4. With the roller at the rear in contact with the ground, adjust the length of the top link so that the lower edge at the side of the flail mower is parallel with the ground.
5. Rotate the blade drum by hand so that a row of blades hang vertically towards the ground.
6. Measure the clearance between the bottom of the extended blades and the ground.
Minimum of 2" or 50 mm.



NOTE: In rough or lumpy ground the clearance needs to be increased to ensure that the blades don't impact the ground during operation.

7. Adjust the roller height to increase or decrease the blade clearance as required.
8. Go through steps 4 to 7 until the required clearance is achieved.

When the Flail Mower has been set up with the required tolerances : Operate the Flail Mower with tractor in low range and the PTO delivering 540 RPM.

Regulating the Tension of Driving Belt

ATTENTION: The mower should always be stopped when adjusting the tension.

Remove the driving belt cover.

1. Loosen the Screw A and B that locks the support shaft and loosen the counter nut C.
2. Loosen the screws that lock the gear box on the mounting plate D.
3. Adjust the drive belt tension. The correct belt tension is achieved when the belt can be deflected by the belt thickness about 13/32" (10mm) at the center point between the pulleys.
4. Align the gearbox so the drive shaft is parallel with the body.
5. Use a straight edge to make sure the belt pulleys are in line and running true. If misaligned call your dealer or service agent for technical support.

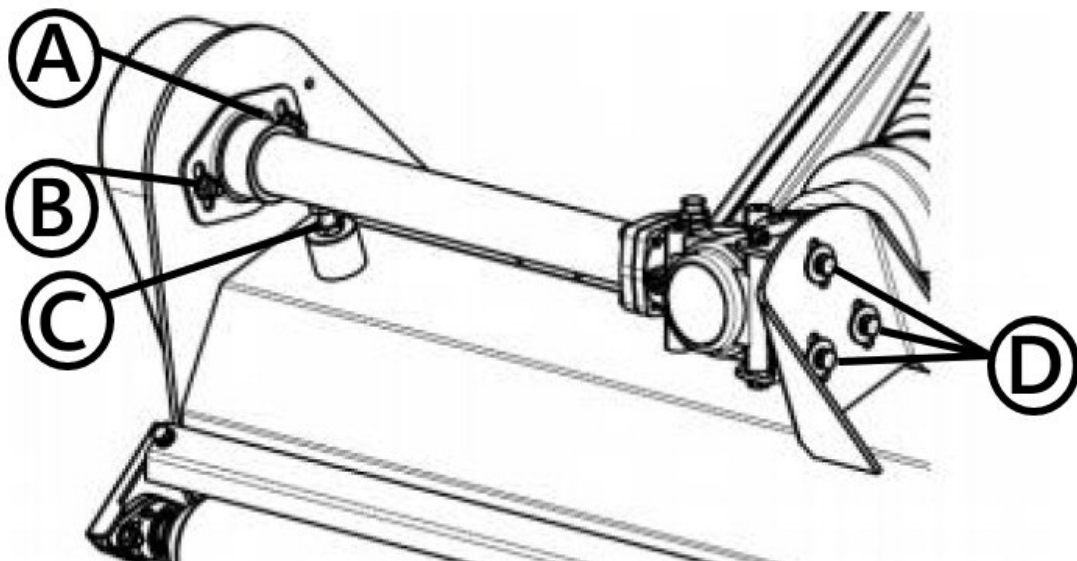

ATTACHING TO TRACTOR



WARNING

Never stand between tractor and mower while backing up tractor to the hitch.

STEP 1 Attach to tractor's category 1 three point hitch as described in the Tractor's Operator's Manual.

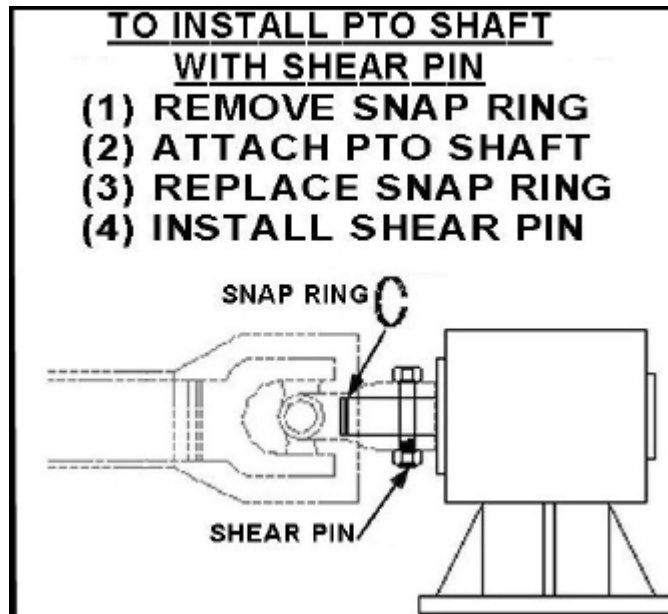

WARNING



Failure to install retaining clip on gearbox input shaft would allow driveline to swing freely if bolt is sheared causing possible injury or death.

STEP 2

Determine if the PTO shaft needs to be shortened.

NOTE:

Due to the many variations in the tractor hitch points and distances between equipment gearbox input shaft and tractor PTO output shafts, some combinations may require PTO shafts to be shortened as described by the following steps.

STEP 3

Raise and lower mower in order to locate the shortest distance between equipment gearbox input shaft and tractor PTO output shaft. With the finishing mower in the shortest distance position shut down the tractor and **SECURELY BLOCK MOWER IN POSITION.**

STEP 4

Pull apart PTO shaft and attach outer section to tractor PTO output shaft. **NOTE:** Be sure to pull on PTO shaft section to ensure yoke has locked into place.

ATTACHING TO TRACTOR *continued....*

STEP 5

Place and hold inner PTO shaft section next to outer section and check if PTO shaft is too long. Each section should end approximately 3 inches short of reaching u-joint shield on the opposite section. If the shaft is too long measure 3 inches back from each u-joint shield and mark the other shaft section. Be sure to do this for both PTO shaft halves. NOTE: Do not cut PTO shaft sections at this time.

STEP 6

Raise mower and remove blocking. Raise and lower mower in order to locate the longest distance between equipment input shaft and the tractor PTO output shaft. With the mower in the longest distance position shut down the tractor and **SECURELY BLOCK THE MOWER IN POSITION.**

STEP 7

As in step 5 hold PTO shaft sections together and check for a minimum of 6 inches of overlap. If PTO shaft has been marked for cutting the overlap is the distance measured between the two marks. If the PTO shaft has less than a 6 inch overlap, **DO NOT USE.** Contact your authorized King Kutter Dealer.

NOTE

If the PTO shaft length is too long go to **SIZING PTO SHAFT (pg. 22)**

STEP 8

Apply any multi-purpose grease to the outside of the male (inner) PTO shaft section. Assemble PTO shaft and install on mower and tractor.

WARNING - Failure to install retaining clip on gearbox input shaft would allow driveline to swing freely if bolt is sheared causing possible injury or death.

STEP 9

Pull on tractor side of PTO shaft yoke to be sure it has locked in place. Make certain PTO shaft shielding is in place and good working condition.

STEP 10

The PTO shaft shield is a non-rotating design and must be secured prior to equipment use. Using the chain on each yoke shield attach to a fixed object on the tractor and equipment ends that will not allow the PTO shaft shield to rotate during operation.

-sizing PTO shaft

check driveline for minimum overlap

With PTO shaft hooked to tractor & Flail Mower raise and lower mower to find PTO's longest extended point and at that point measure length of cover of the PTO at **(A)**, transfer the measurement of **(A)** to **(B)**, mark cover at the end of measurement of **(B)**,

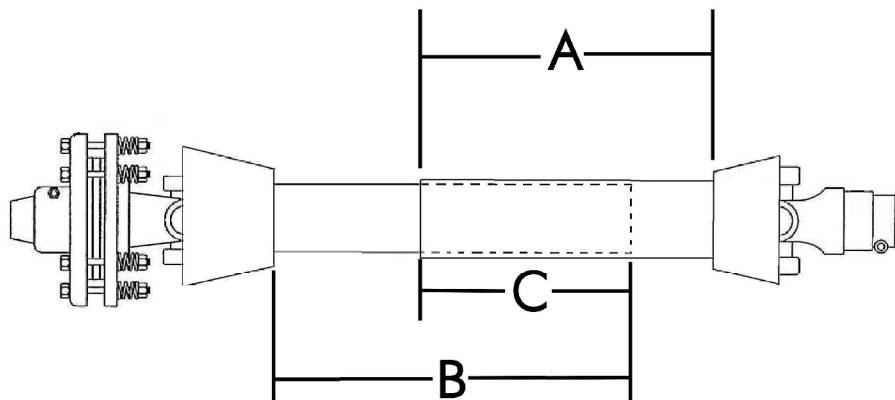

STEP 1

Cutting the PTO shaft to length. **NOTE:** Be sure to cut equal lengths of each PTO shaft section. Clamp end of PTO shaft in a vice and cut off shield where marked. **(Figure 1-A & 1-B)**

STEP 2

Using cut section of the shield as a guide cut shaft off the same amount. **(Figure 2)**

STEP 3

Repeat steps 1 and 2 for other PTO shaft section.

STEP 4

Use a file to deburr PTO shafts. Clean up all chips, burrs and filings from both ends of the PTO shaft.



Figure 1-A



Figure 1-B



Figure 2

SERVICE AND MAINTENANCE

SERVICE

Fluids and lubricants

1. Grease: Use multi-purpose lithium based grease.
2. Gearbox Oil: Use N46 or AW46 drive & hydraulic dual-purpose oil or equivalent for all operating conditions. Gearbox Capacity: 0.85 liter or (almost a quart)
3. Storing Lubricants: Your machine can operate at top efficiency only if clean lubricants are used. Use clean containers to handle all lubricants. Store them in an area protected from dust, moisture and other contaminants.

GREASING

- Use a hand-held grease gun for all greasing.
- Wipe grease zerk with a clean cloth before greasing, to avoid injecting dirt and grit.
- Replace and repair broken zerk immediately.
- If zerk will not take grease, remove and clean thoroughly. Also clean lubricant passageway. Replace zerk if necessary.
- Check the oil in gearbox. Add oil if necessary.
- Every 8 hours, grease each end of the blade axle 3-5 shots (**See Figure 1 Below**), PTO shaft universal joints (2), and PTO telescoping surface. (**See Figure 2 Below**)



MAINTENANCE

ATTENTION: All maintenance, repairs, cleaning and lubricating should be conducted when the tractor and mower are stopped and the key is removed.

By following a careful service and maintenance program for your mower, you will enjoy many years of trouble-free operation.

The period recommended is based on normal operating conditions. Severe or unusual conditions may require more frequent maintenance.

8 HOURS OR DAILY MAINTENANCE

- Check and tighten all nuts and bolts on mower.
- Check the blade and parts every day and replace parts that are damaged. Don't install damaged, worn and unbalanced blades. A new sleeve should be used when replacing the blades.

NOTE: The operator should wear gloves and use the correct tools while changing the blade.

- Clean the mower; remove all grass, debris and dirt.

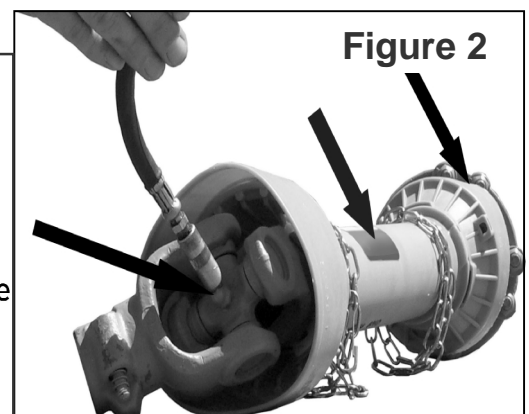
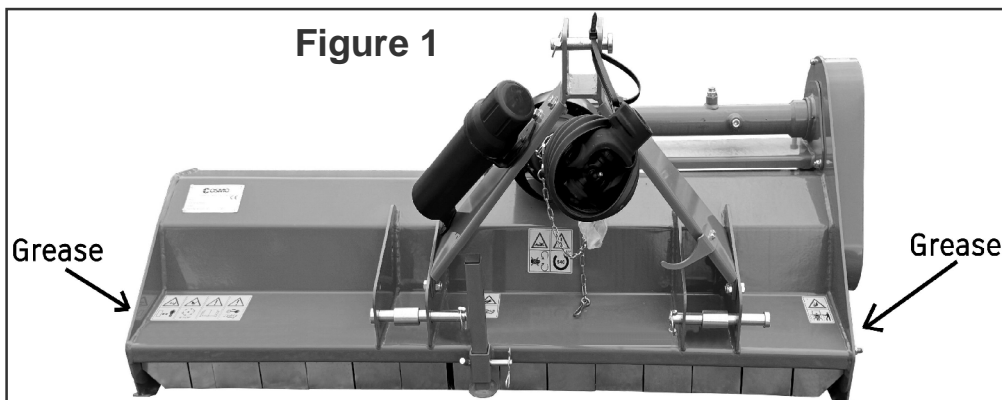

STORAGE

The mower should be cleaned thoroughly to avoid corrosion.

Don't spray water on the roller bearing, if you clean the mower with high pressure sprayer.

Check and clean the PTO shaft, driving belt press roller, or replace them if they are worn or damaged.

Put a light coat of oil on parts to resist corrosion.

Repaint the parts scratched and damaged to deter corrosion.

Store the mower in a dry, level area. Block the mower for storage.

OPERATION AFTER STORAGE

Before the mower is started up, check the following items regularly:

Check oil level and add if it is low.

Check and tighten all bolts and nuts.

Check the overall condition of the mower.

Check the condition of the blades.

Check the air hole on the gearbox. If it is blocked, clean or open the hole with compressed air.

Don't get oil or grease on the driving belts. If there is oil or grease on the belts, wipe the belts, to prevent the belt from slipping and wearing.

ATTENTION: Check the machine every 10 hours. Repair or replace the damaged parts according to the manufacturer's recommendation, to keep the machine in good working condition.

Check all parts, to make sure that they are in good condition and replace them if necessary.

Don't remove the protective shields that protect the mower and operator.

ATTENTION: In the case of vibration, stop the mower and check the blades. If the blade has broke or is damaged, replace it with same type of blade. If the mower still vibrates, call your authorized dealer.

FLAIL MOWER PARTS DIAGRAM

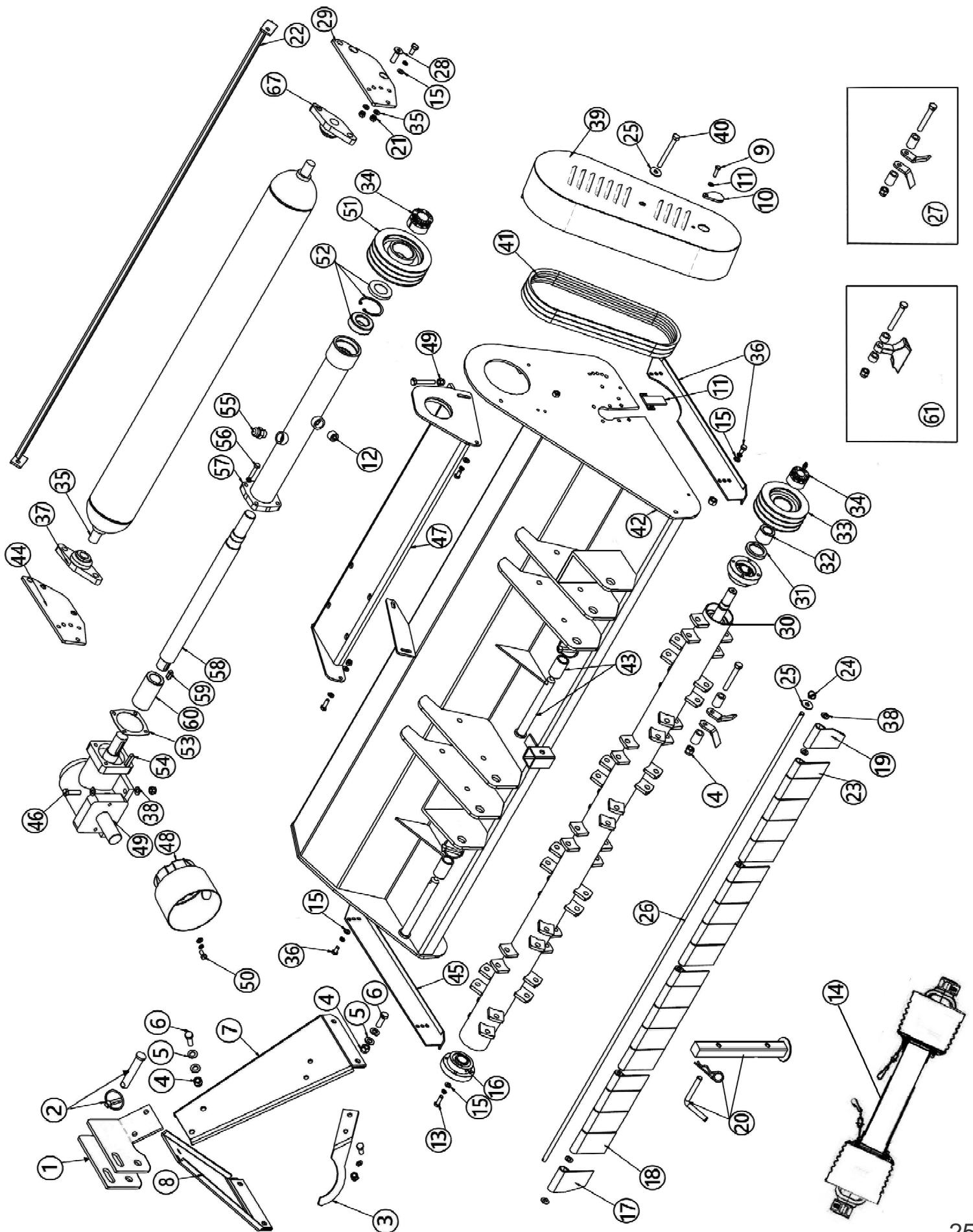

FLAIL MOWER PARTS

Ref. No.	Part Name	Part #
1	TOP LINK BRACKET	391800
2	TOP LINK PIN w/Lynch Pin	507100
3	PTO HANGER FLAIL MOWER	507101
4	NUT 12MM	391884
5	WASHER 12MM	391883
6	BOLT 12MM x 30MM	391882
7	LIFT ARM LH FLAIL MOWER	391803
8	LIFT ARM RH FLAIL MOWER	391804
9	6MM X 20MM BOLT	391876
10	COVER	391874
11	GREASE NIPPLE COVER	391875
12	PLUG ZG 3/8" -19	391873
13	BOLT 8MM x 25MM	391881
14	26" PTO SHAFT	147126
15	WASHER 8	391880
16	BEARING UC205 W/SEAT	391809
17	FENDER	391810
18	FENDER	391811
19	FENDER	391812
20	KICK STAND ASSEMBLY	507102
21	SCRAPER FOR FL-56-KK SCRAPER FOR FL-65-KK	391870 391871
22	10MM NUT	391872
23	FENDER	391813
24	COTTER PIN 4MM x 30MM	391879
25	10MM FLAT WASHER	391836
26	SHAFT FOR FENDER FL-56-KK SHAFT FOR FENDER FL-65-KK	391817 391818
27	Y BLADE PACKAGE (2 BUSHINGS, 2 BLADES, 1 BOLT, 1 NUT)	507103
28	10MM X 25MM COUNTER SUNK SCREW	391869
29	CONNECTION PLATE REAR ROLLER RH	391868
30	AXLE FL-56-KK AXLE FL-65-KK	391823 391824
31	OIL SEAL 40 X 55 X 8	391825
32	BUSHING	391826
33	SMALL PULLEY	391827
34	POWER LOCK W/GREASE ZERK	507104
35	REAR ROLLER WELDMENT FL-56-KK REAR ROLLER WELDMENT FL-65-KK	391866 391867
36	LEFT HAND SKID KIT	507105
37	BEARING L204	391865

FLAIL MOWER PARTS

Ref. No.	Part Name	Part #
38	10MM FLAT WASHER	391833
39	SIDE BELT COVER	391834
40	10MM X 80MM BOLT	391835
41	BELT A930 (PKG 3)	507112
42	DECK WELDMENT FOR FL-56-KK DECK WELDMENT FOR FL-65-KK	391838 391839
43	HITCH PIN KIT	507106
44	CONNECTION PLATE REAR ROLLER LH	391864
45	RH SKID KIT	507107
46	10MM X 35MM BOLT	391877
47	GEARBOX WELDMENT BRACKET FOR FL-56-KK GEARBOX WELDMENT BRACKET FOR FL-65-KK	507108 507109
48	PTO SHAFT GUARD	391862
49	GEARBOX FLAIL MOWER	391863
50	8MM X 10MM BOLT	391878
51	LARGE PULLEY	391848
52	OIL SEAL,SNAP RING,BRG. KIT	507110
53	GASKET	391860
54	KEY A 10*45	391861
55	BREATHE BOLT	391852
56	8MM X 40MM BOLT	391853
57	TRANSMISSION SHAFT WELDMENT FOR FL-56-KK TRANSMISSION SHAFT WELDMENT FOR FL-65-KK	391854 391855
58	SHAFT FOR FL-56-KK SHAFT FOR FL-65-KK	391856 391857
59	KEY A 10*30	391858
60	CONNECT BUSHING	391859
61	HAMMER BLADE PKG. (2 BUSHINGS, 1 BLADE, 1 BOLT, 1 NUT)	507111



1. Limited Warranty.

King Kutter, Inc. ("King Kutter"), P.O. Box 1200, Winfield, Alabama 35594, warrants to the original retail purchaser ("Purchaser") that the product that is the subject of this sale is free from defects in material and workmanship at the time of sale.

Under this warranty, King Kutter will repair the defective product free of charge to the Purchaser, with either new or used and reconditioned replacement parts. All warranty service will be performed at service centers designated by King Kutter. If King Kutter is unable to repair the product to conform to the warranty after a reasonable number of attempts, King Kutter will provide, at its option, one of the following: (a) a replacement for the product or, (b) a full refund of the purchase price. Repair, replacement, or refunds are the Purchaser's EXCLUSIVE remedies against King Kutter under this limited warranty. King Kutter will not be liable for any special, incidental or consequential damages based upon breach or warranty, breach of contract, negligence, strict tort liability, or any other legal theory. Such damages include, but are not limited to, loss of profits, loss of savings or revenue, loss of use of the product or any associated equipment, cost of capital, cost of any substitute equipment, facilities or services, down time, the claims of third parties including customers, and injury to property. These limitations also apply, to the extent allowed by law, to personal injury.

The purchaser must notify the Seller in writing of any defect in material or workmanship within one (1) year following the date of purchase. If the equipment is used for commercial purposes, the Purchaser must notify the Seller in writing of any defect in material or workmanship within ninety (90) days following the date of purchase. In no event will King Kutter be liable under this warranty unless written notice is received by the Seller within one (1) year from the date of original retail sale.

2. Warranty of Title.

King Kutter warrants that it transfers a good title to the product free of any encumbrances, and free of the rightful claim of any third party for infringement of patent or copyright.

3. What is Not Covered by This Limited Warranty.

King Kutter will not be responsible for damage to or failure in the product which results from accident, misuse, abuse, neglect, installation of attachments not provided by King Kutter, modifications to the product, or damage caused by use of the product for purposes other than those for which it was designed.

4. No Other Warranties.

Unless modified in writing and signed by both parties, this agreement is understood to be the complete and exclusive agreement and warranty between King Kutter and Purchaser, superseding all prior agreements, oral and written, and all other communication between King Kutter and Purchaser related to the subject matter of this agreement.

THIS LIMITED WARRANTY IS IN LIEU OF ALL OTHER WARRANTIES, EXPRESS OR IMPLIED, INCLUDING, BUT NOT LIMITED TO, THE IMPLIED WARRANTY OF MERCHANTABILITY AND THE IMPLIED WARRANTY OF FITNESS FOR A PARTICULAR PURPOSE. No employee of King Kutter nor anyone else is authorized to make any warranty or representation in addition to or different from those made in this agreement.

5. Allocation of Risk.

This agreement allocates the risk of product failure between King Kutter and the Purchaser. This Allocation is recognized by both parties as reflected in the price of the goods. The Purchaser acknowledges that he or she has read this agreement, understands it, and is bound by its terms.